

014112

Providence R. I.  
This plat accompanies  
our report of this date.

# PLAT OF FEDERAL STREET

FROM FOUNTAIN ST TO DEAN ST.

IN TWO SHEETS

SCALE 50 FEET PER INCH.

*Changed to Cope St., from Broadway  
easterly, May 16, 1895.*

This triangle was declared  
a Public Highway by the  
Board of Aldermen  
Mar. 19, 1914.  
Deed Book 540-335.

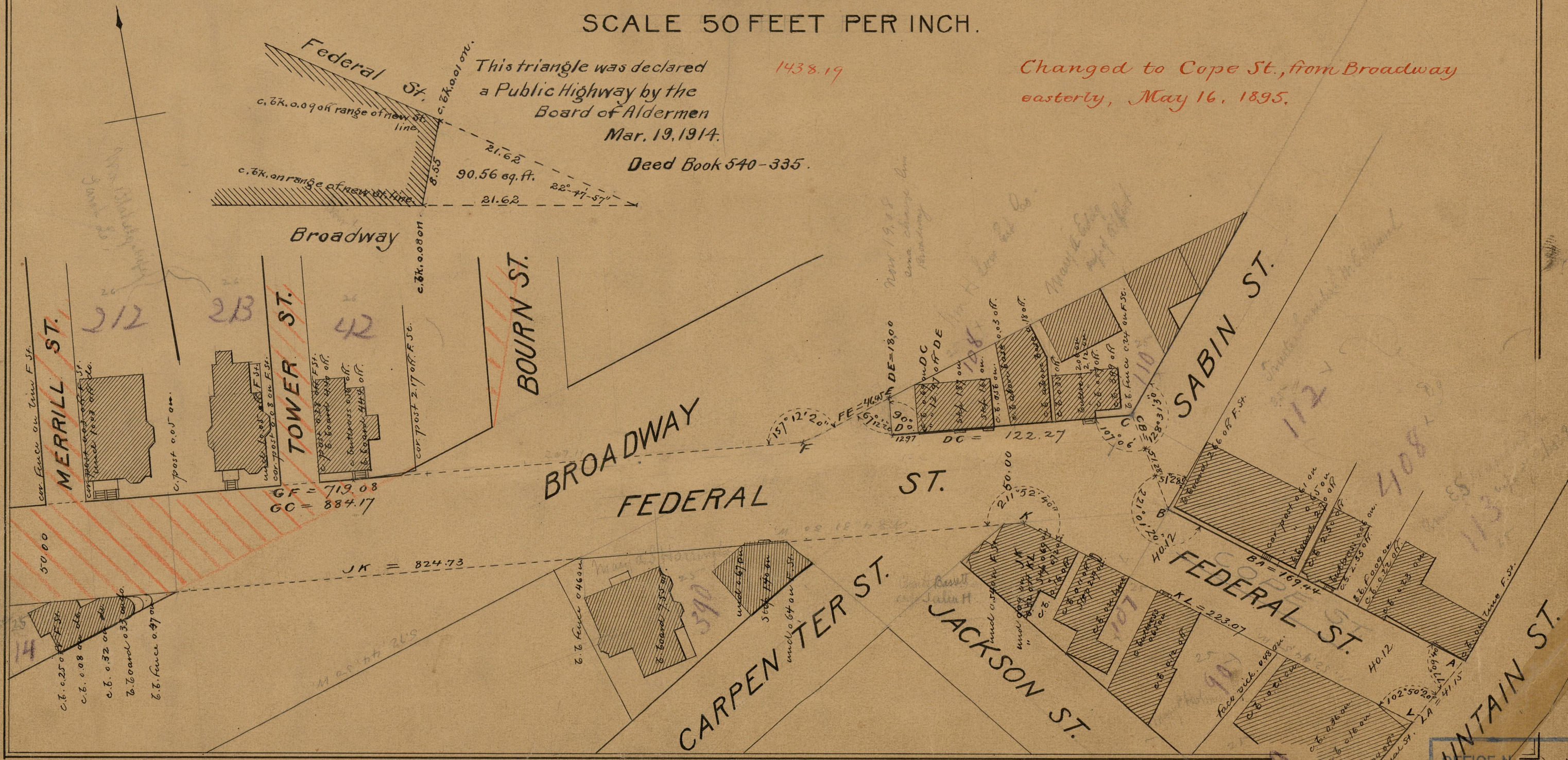

OFFICE No.	9754
DRAWER	83
SHEET	B-3